



European Union  
Motorcycle Européenne  
Union de Motocyclisme



## Motocross European Championships Supplementary Regulations

Title of the meeting: EMX65/EMX85 European Championship NW And EMX QUAD

Venue: Honda Park DK EMN: 20/6

Classes: EMX 85 / EMX 65, NW Europe zone + EMX QUAD Date: 15-17 May 2015

Organizing FMN: DMU Country: Denmark

---

### Access:

Nearest Airport: Aarhus Airport at: 39 km from the circuit

Motorway: E45 National Road: 180

Nearest town: Randers at: 9 km from the circuit

Direction: North/West ( North/South/West/East)

Nearest Hospital: Regions Hospital Randers at: 10 km from the circuit

Hospital Address: Skovlyvej 1

DK 8930 Randers

Phone: + 45 7011 3131 Fax: + 45 7842 4334

---

**1. ORGANIZER:** Randers Motor Sport

Address: Postboks 153

DK 8960 Randers SØ

Phone: + 45 4018 7733/ +45 4033 9608 Fax: + \_\_\_\_\_

E-Mail: [epesoe@post11.tele.dk](mailto:epesoe@post11.tele.dk) / [pgjfirma@gefiber.dk](mailto:pgjfirma@gefiber.dk)

Web.Site: [rms.dk](http://rms.dk)

## **2. ENTRIES:**

Entry forms duly approved by the participants must be send to:

**Danmarks Motor Union**

Address:

**Brøndby Stadion 20**

**DK 2605 Brøndby**

Phone: + **45 4326 2613**

Fax: + **45 4326 2615**

E-Mail:

[dmu@dmusport.dk](mailto:dmu@dmusport.dk)

**not later than: 15-04-2015** (30 days before the meeting)

## **3. SECRETARIAT OF THE MEETING:**

**Honda Park DK v/Randers Motor Sport**

Address:

**Clausholmvej 180**

**DK 8960 Randers SØ**

Phone: + **45 4018 7733/ +45 4033 9608**

Fax: +

E-Mail:

[epesoe@post11.tele.dk](mailto:epesoe@post11.tele.dk) / [pgjfirma@gefiber.dk](mailto:pgjfirma@gefiber.dk)

## **4. WELCOME CENTER:**

Place:

Open on:

Thursday:

from:

**18:00**

to:

**22:00**

Friday:

from:

**7:00 AM**

to:

**10:00 PM**

Saturday:

from:

**7:00 AM**

to:

**6:00 PM**

Sunday:

from:

**3:00 PM**

to:

**7:00 PM**

## **5. CIRCUIT:**

Name of the circuit:

**Honda Park DK**

Length of the course:

**1610**

m.

Minimum width:

**6**

m.

A drawing of the circuit is attached to these regulations.

The race office must be equippt with a high speed internet connection over the whole meeting.

## **6. OFFICIALS:**

Jury President:	<u>Hans-Rudolf Hein</u>	FIM Lic. Nr.	<u>                    </u>
FMNR-Jury Member:	<u>Peter Hansen</u>	FIM Lic. Nr.	<u>8878</u>
UEM-Jury Member:	<u>N/A</u>	FIM Lic. Nr.	<u>                    </u>
Race-Director:	<u>N/A</u>	FIM Lic. Nr.	<u>                    </u>
Secretary of the Jury:	<u>Poul Erik Sørensen</u>		
Clerk of the course:	<u>Peter Guldberg Johansen</u>	FIM Lic. Nr.	<u>7913</u>
Secretary of the Meeting:	<u>Kasper Darfelt</u>		
Chief Technical Steward:	<u>Martin Skov Jensen</u>	FIM Lic. Nr.	<u>7539</u>
Chief Timekeeper:	<u>Kristian Lang</u>	FIM Lic. Nr.	<u>                    </u>
Environmental Steward:	<u>Jesper Rasmussen</u>	FIM Lic. Nr.	<u>10100</u>
Chief Medical Officer:	<u>TBA</u>	FIM Lic. Nr.	<u>                    </u>
Press Officer:	<u>Martin Wigh Knudsen</u>		
Paddock Official:	<u>Jan Hvam</u>		

The meeting will be organized in conformity with the UEM Sporting Code, the UEM MX rules, the CMS Regulations, the general rules of the **DMU** (FMNR), where applicable, and this Supplementary Regulations which have been duly examined and approved by the **DMU** (FMNR).

## **7. STARTING NUMBERS:**

All riders will receive from the UEM Motocross Commission a permanent starting number to be used for the entire season. Changing during the season without prior written approval of the UEM Motocross Commission is not possible.

## **8. CIRCUIT CONTROL:**

Meeting point: At the starting grid.  
See attached Time Schedule.

## **9. MEETING WITH THE ORGANIZERS**

Venue: Jury room.

See attached Time Schedule.

## **10. TECHNICAL CONTROL AND VERIFICATIONS.**

Venue: The Technical control post.

See attached Time Schedule.

## **11. JURY MEETINGS**

Venue: The Jury room.

See attached Time Schedule.

## **12. RIDERS BRIEFING:**

Meeting point: At the starting grid.

See attached Time Schedule.

## **13. PRACTISE:**

See attached Time Schedule

## **14. QUALIFYING:**

See attached Time Schedule

## **15. FREE START SESSION:**

See attached Time Schedule

## **16. WARM UP:**

See attached Time Schedule

## **17. SIGHTING LAP:**

See attached Time Schedule

## **18. WAITING ZONE:**

See attached Time Schedule

## **19. RACES:**

See attached Time Schedule

## **20. FUEL:**

In according with FIM specifications.

## **21. INSURANCE:**

By endorsing the application form for entry, the FNM of the rider certifies that the rider is insured in according with the UEM requirements.

The organizer has contacted a third party insurance in according with Art. 110.1 of the UEM Sporting Code. This insurance includes a guarantee of the minimum amount as stipulated by the UEM Management Council. The Insurance comes in effect 2 days before the first practise and ends 2 days after the meeting.

The organizer disclaims all responsibility for damage to a motorcycle, its accessories and components arising out of an accident, fire or other incident.

## **22. PROTEST AND APPEALS:**

Any person or group of persons (rider, entrant, manufacturer, official, etc.), recognized by the FIM and concerned by a decision taken under the authority of the UEM, may ask for redress for the consequences of that decision.

Protest must be lodged according to the UEM Disciplinary and Arbitration Code and the Supplementary Regulations and be accompanied by a fee of 130,- € or equivalent amount in local currency, returnable if the protest is justified.

In general, protests against eligibility of a rider entered, must be made before the start of the official practice.

Protests against results must be presented to the International Jury within 30 minutes following the publishing of the results.

An appeal can be made to the UEM Disciplinary Commission against a decision of the International Jury.

Protest entailing a fuel control: See UEM MX rulebooks.

## **23. PRICE-GIVING CEREMONY:**

Venue of the prize-giving ceremony:

See attached Timetable.

The first three riders are invited to attend the prize-giving ceremony.

Additional other riders can be invited by Youthstream or the organizer. Riders might also be invited for a Press Conference.

If invited attendance to the prize giving ceremony or press conference is compulsory.

## **24. INTERPRETATION OF THE SUPPLEMENTARY REGULATIONS:**

The interpretation of this regulations rests entirely with the Jury. In case of dispute, regarding the interpretation or if there is any difference between the two official texts, the English text will prevail.

## **25. MISCELLANEOUS:**

The maximum fee for Transponders rent is 100.-€, the fee has to payed back after return of the Transponder.

**The entry fee of 100.-€ must be payed at the Technikal Control**

Place and date: Sabro d. 6/4-2015

The race office is equippt with a high speed internet connection over the whole meeting.

The Clerk of the Course: Peter Guldborg Johansen

Approved by FMNR: \_\_\_\_\_

Appoved by UEM: Eddie Herd 09/04/2015

## **Attachmend:**

A map of the region, including the venue of the circuit

Time Scedule

Drawing of the circuit

map of the region

WGS84:N 56° 24.408', E 10° 7.643' WGS 84 - decimal: 56.40680, 10.12738.  
 Adresse Clausholmvej 160  
 8960 Randers



map of the track

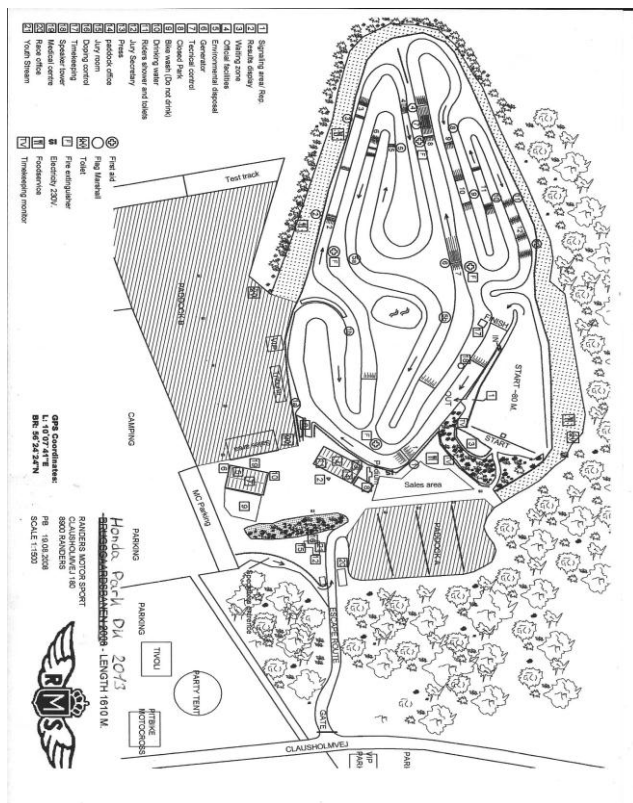

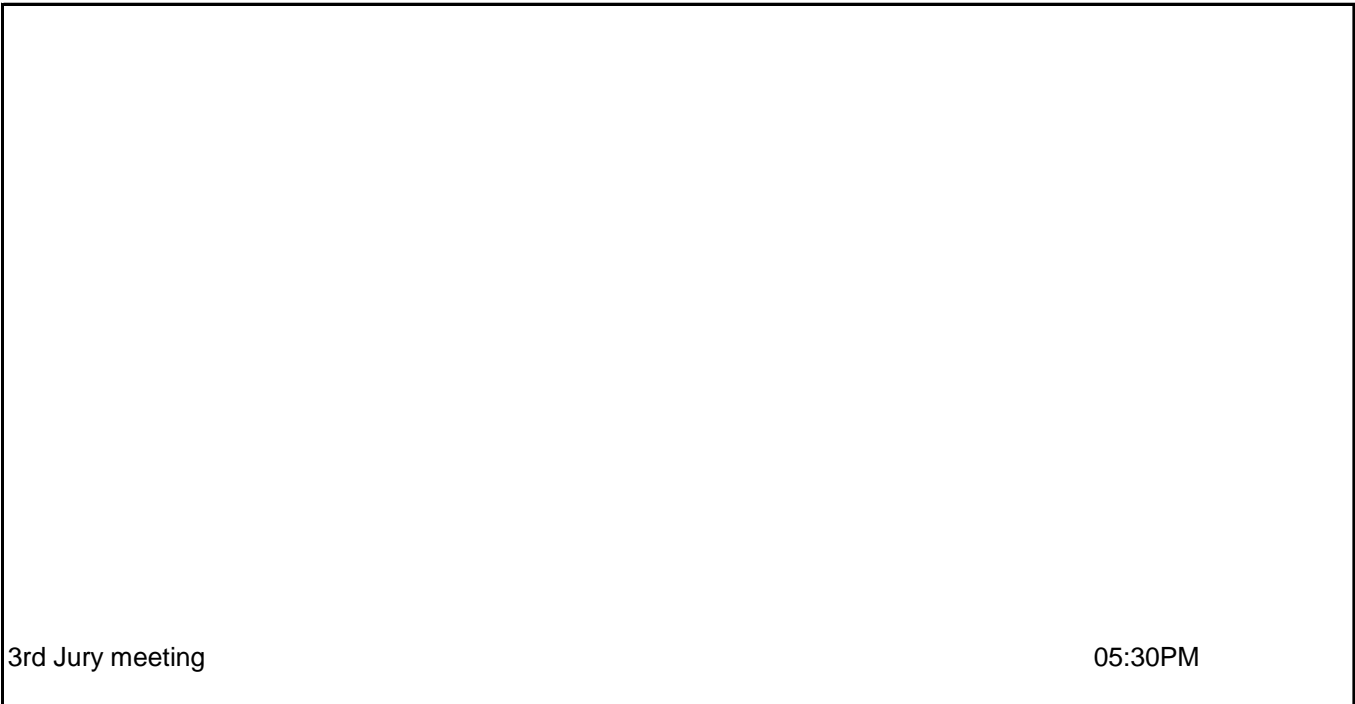
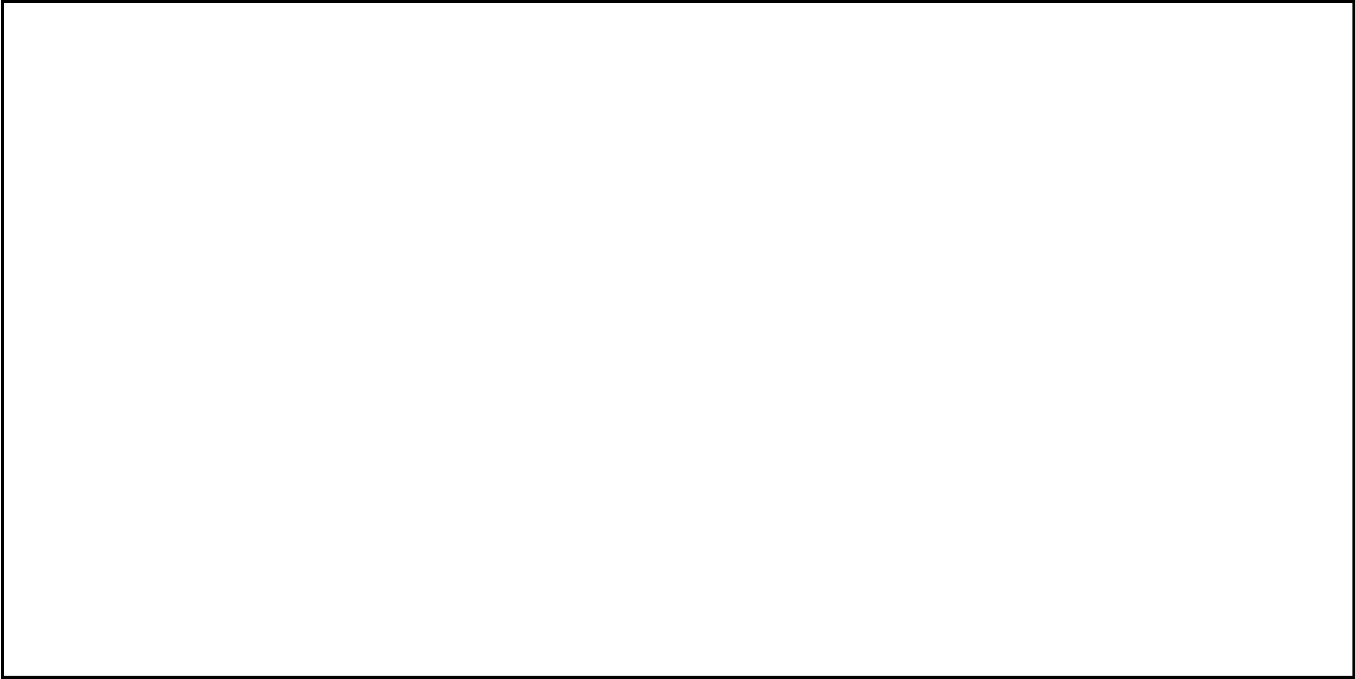



3rd Jury meeting

17:30



